**FAG****53306**

Axial deep groove ball bearing

Schaeffler ID:
0190071240000

Axial deep groove ball bearing 533, single direction, with spherical housing washer, steel sheet metal cage

Technical information

Main Dimensions & Performance Data

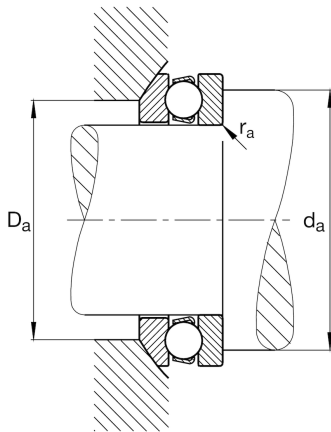
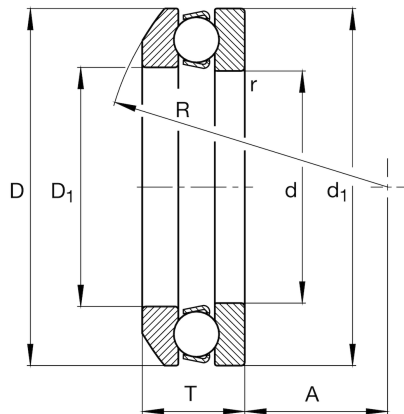

d	30 mm	Bore diameter
D	60 mm	Outside diameter
T	22.6 mm	Height
C_a	35,500 N	Basic dynamic load rating, axial
C_{0a}	65,000 N	Basic static load rating, axial
C_{ua}	2,950 N	Fatigue load limit, axial
n_G	5,700 1/min	Limiting speed
n_{gr}	9,300 1/min	Reference speed
	0.261 kg	Weight

Dimensions

r_{min}	1 mm	Minimum chamfer dimension
D_1	32 mm	Bore diameter housing washer
d_1	60 mm	Lip diameter shaft washer
R	50 mm	Radius spherical housing washer
A	22 mm	Distance of the center point
T_1	25 mm	Height with seat washer

Mounting dimensions

$d_{a min}$	48 mm	Minimum diameter shaft shoulder
$D_{a max}$	45 mm	Maximum diameter of housing shoulder
$r_{a max}$	1 mm	Maximum recess radius

Additional information

A	0.028	Minimum load factor
	U306	Seat washer

Temperature range

T_{min}	-30 °C	Operating temperature min.
T_{max}	150 °C	Operating temperature max.